

ROLLER SHADE

CHANNEL INSTALLATION RESOURCE

OUTSIDE MOUNT

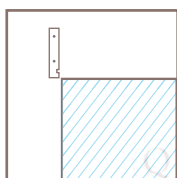

BRACKET IN PLACE Brackets are mounted (see Roller Shade Installation Instructions for more details about this step.)

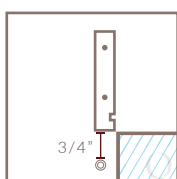

SIDE CHANNEL INSTALLATION Measure $\frac{3}{4}$ " from the outside edge and bottom of bracket for the location of the first button.

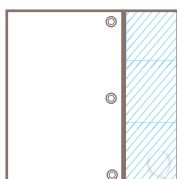

Continue using the same reference point downward to mount two more buttons evenly spaced along the side of the window.

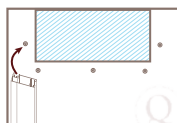

Using your hand with force, tap the channel onto the buttons (avoid using tools with this step as it could damage the channel if too much force is used and the outside coating on the channel could be impaired).

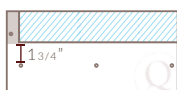

SILL CHANNEL INSTALLATION Now that side channels are mounted, measure $1\frac{3}{4}$ " from the bottom of the side channel. That is your mounting point for the U-sill-channel. Using the same reference point horizontally, mount the remaining buttons. Tap channel into the buttons the same way as done for side channels.

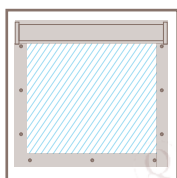

NOTES

- If mounting between side channels, mount side first then position and mount sill.
- Our U channels are multi-purpose—they can be used for inside or outside, as well as side and sill mounting.



QUILT CRAFT